

4" Horizontal Discharge - Submersible Non-Clog Pumps

DISCHARGE 4" 125lb., Flange Horizontal
LIQUID TEMPERATURE 104°F (40°C) Continuous
VOLUTE Cast Iron ASTM A-48, Class 30
MOTOR HOUSING Cast Iron ASTM A-48, Class 30
SEAL PLATE Cast Iron ASTM A-48, Class 30
IMPELLER:
 Design 2 Vane, Open with pump out vanes on back side, Dynamically Balanced, ISO G6.3
 Material Cast Iron ASTM A-48, Class 30
SHAFT 416 Stainless Steel
SQUARE RINGS Buna-N
DIAPHRAGM Buna-N
HARDWARE 300 Series Stainless Steel
LIFTING BAIL 304 Stainless Steel
PAINT Air Dry Enamel (Epoxy Optional)
SEAL:
 Design Double Mechanical, Oil filled pressure equalized reservoir
 Material Carbon/Ceramic/Buna-N
 Hardware - 300 Series Stainless
CORD ENTRY 40 ft. (12.1 m) Cord. Epoxy Sealed Housing with secondary pressure grommet for sealing and strain relief
SPEED 1150 or 1750 RPM (Nominal)
BEARINGS:
 Upper Single Row, Ball, Oil Lubricated
 Load Radial
 Lower Single Row, Ball, Oil Lubricated
 Load Radial
 Life 50,000 HR L10 Design
MOTOR:
 Design NEMA L- Single Phase, NEMA B - Three Phase Torque Curve, Oil Filled, Squirrel Cage Induction
 Winding Class B, Class H rated Magnet Wire
 Service Factor 1.15
SINGLE PHASE Permanent Split Capacitor (PSC) Includes Overload Protection in Motor
THREE PHASE 200-230/460/575 is Tri Voltage motor. Requires Overload Protection to be included in Control Panel, VFD Suitable
MOISTURE SENSOR Normally Open (N/O), Requires relay in control panel
TEMPERATURE SENSOR .. Normally Closed (N/C), Requires relay in control panel. For three phase units ONLY
OPTIONAL EQUIPMENT Seal Material, Impeller Trims, Additional Cord, Epoxy Paint

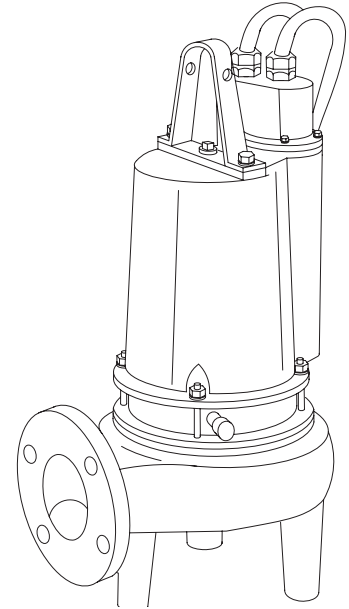

Series: 4SE 1.9 & 2.8HP,
1150RPM, 60Hz
 Series: 4SE 2.8, 3.7, 5.0HP,
1750RPM, 60Hz



Sample Specifications: Section 1 Page 11.

DESCRIPTION:

SUBMERSIBLE NON-CLOG SEWAGE PUMP
DESIGNED FOR TYPICAL RAW SEWAGE
APPLICATIONS

Series 4SE-L

3" Spherical Solids Handling
Double Seal

BARNES®

www.cranepumps.com

4" Horizontal Discharge - Submersible Non-Clog Pumps

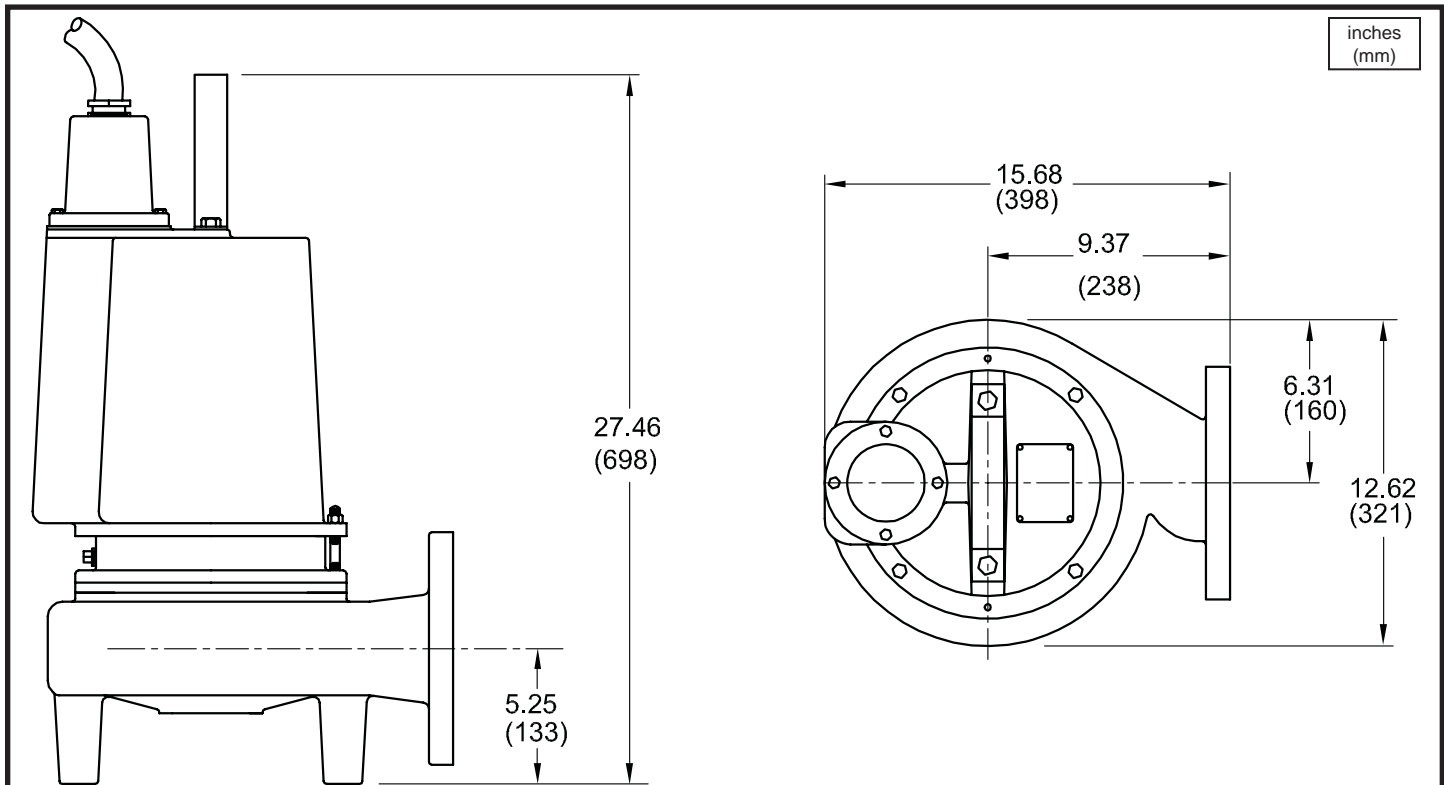

MODEL NO	PART NO	HP	VOLT/PH	Hz	RPM (Nom)	NEMA START CODE	FULL LOAD AMPS	LOCKED ROTOR AMPS	CORD SIZE	CORD TYPE	CORD O.D. inch (mm)
4SE1926L	084602	1.9	230/1	60	1150	D	8.3	35.0	10/3	SOW	0.690 (17.5)
4SE1996L	084604	1.9	200-230/3	60	1150	E/G	5.8/5.0	26.1/30.0	10/4	SOW	0.750 (19.1)
4SE1946L	084605	1.9	460/3	60	1150	G	2.5	15.0	10/4	SOW	0.750 (19.1)
4SE1956L	089300	1.9	575/3	60	1150	G	2.0	12.0	10/4	SOW	0.750 (19.1)
4SE2826L	088825	2.8	230/1	60	1150	A	13.5	31.0	10/3	SOW	0.690 (17.5)
4SE2896L	088826	2.8	200-230/3	60	1150	F/H	9.2/8.4	38.2/44.0	10/4	SOW	0.750 (19.1)
4SE2846L	088827	2.8	460/3	60	1150	H	4.2	22.0	10/4	SOW	0.750 (19.1)
4SE2856L	088828	2.8	575/3	60	1150	H	3.4	17.6	10/4	SOW	0.750 (19.1)
4SE2824L	084606	2.8	230/1	60	1750	A	12.6	23.0	10/3	SOW	0.690 (17.5)
4SE2894L	084608	2.8	200-230/3	60	1750	D/H	9.2/8.0	35.9/42.7	10/4	SOW	0.750 (19.1)
4SE2844L	084609	2.8	460/3	60	1750	G	4.0	18.0	10/4	SOW	0.750 (19.1)
4SE2854L	089301	2.8	575/3	60	1750	F	3.2	14.4	10/4	SOW	0.750 (19.1)
4SE3724L	084610	3.7	230/1	60	1750	A	20.0	29.0	10/3	SOW	0.690 (17.5)
4SE3794L	084611	3.7	200-230/3	60	1750	B/E	12.6/10.9	35.9/42.7	10/4	SOW	0.750 (19.1)
4SE3744L	084612	3.7	460/3	60	1750	E	5.4	21.3	10/4	SOW	0.750 (19.1)
4SE3754L	089302	3.7	575/3	60	1750	G	5.6	21.6	10/4	SOW	0.750 (19.1)
4SE5024L	088821	5.0	230/1	60	1750	A	28.0	59.0	10/3	SOW	0.690 (17.5)
4SE5094L	088822	5.0	200-230/3	60	1750	B/D	20.9/19.0	48.6/56.0	10/4	SOW	0.750 (19.1)
4SE5044L	088823	5.0	460/3	60	1750	D	9.0	28.0	10/4	SOW	0.750 (19.1)
4SE5054L	088824	5.0	575/3	60	1750	E	8.3	23.0	10/4	SOW	0.750 (19.1)

Moisture/Temperature sensor cord for all phase models is 18/5 SOW, 0.476 (12.1mm) O.D.

IMPORTANT !

- 1.) PUMP MAY BE OPERATED "DRY" FOR EXTENDED PERIODS WITHOUT DAMAGE TO MOTOR AND/OR SEALS.
- 2.) THIS PUMP IS APPROPRIATE FOR THOSE APPLICATIONS SPECIFIED AS CLASS I DIVISION II HAZARDOUS LOCATIONS.
- 3.) THIS PUMP IS NOT APPROPRIATE FOR THOSE APPLICATIONS SPECIFIED AS CLASS I DIVISION I HAZARDOUS LOCATIONS.
- 4.) INSTALLATIONS SUCH AS DECORATIVE FOUNTAINS OR WATER FEATURES PROVIDED FOR VISUAL ENJOYMENT MUST BE INSTALLED IN ACCORDANCE WITH THE NATIONAL ELECTRIC CODE ANSI/NFPA 70 AND/OR THE AUTHORITY HAVING JURISDICTION. THIS PUMP IS NOT INTENDED FOR USE IN SWIMMING POOLS, RECREATIONAL WATER PARKS, OR INSTALLATIONS IN WHICH HUMAN CONTACT WITH PUMPED MEDIA IS A COMMON OCCURRENCE.

SECTION 1D
PAGE 8
DATE 7/07

CRANE®

A Crane Co. Company

PUMPS & SYSTEMS

USA: (937) 778-8947 • Canada: (905) 457-6223 • International: (937) 615-3598

4" Horizontal Discharge - Submersible Non-Clog Pumps

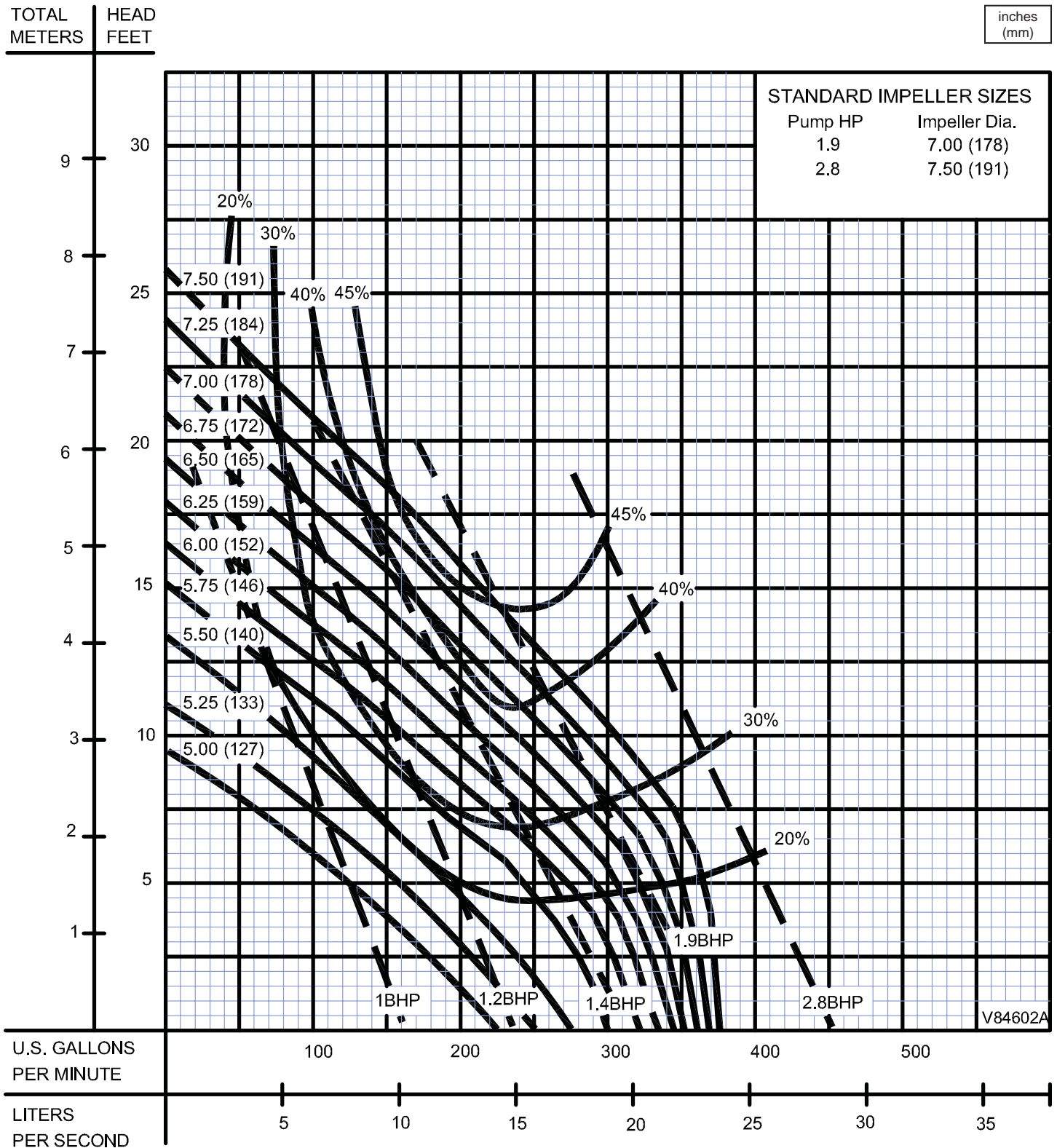

STANDARD IMPELLER SIZES	
Pump HP	Impeller Dia.
1.9	7.00 (178)
2.8	7.50 (191)

Testing is performed with water, specific gravity 1.0 @ 68° F @ (20°C), other fluids may vary performance

Series 4SE-L

Performance Curve

2.8, 3.7 & 5.0HP, 1750RPM, 60Hz



www.cranepumps.com

4" Horizontal Discharge - Submersible Non-Clog Pumps

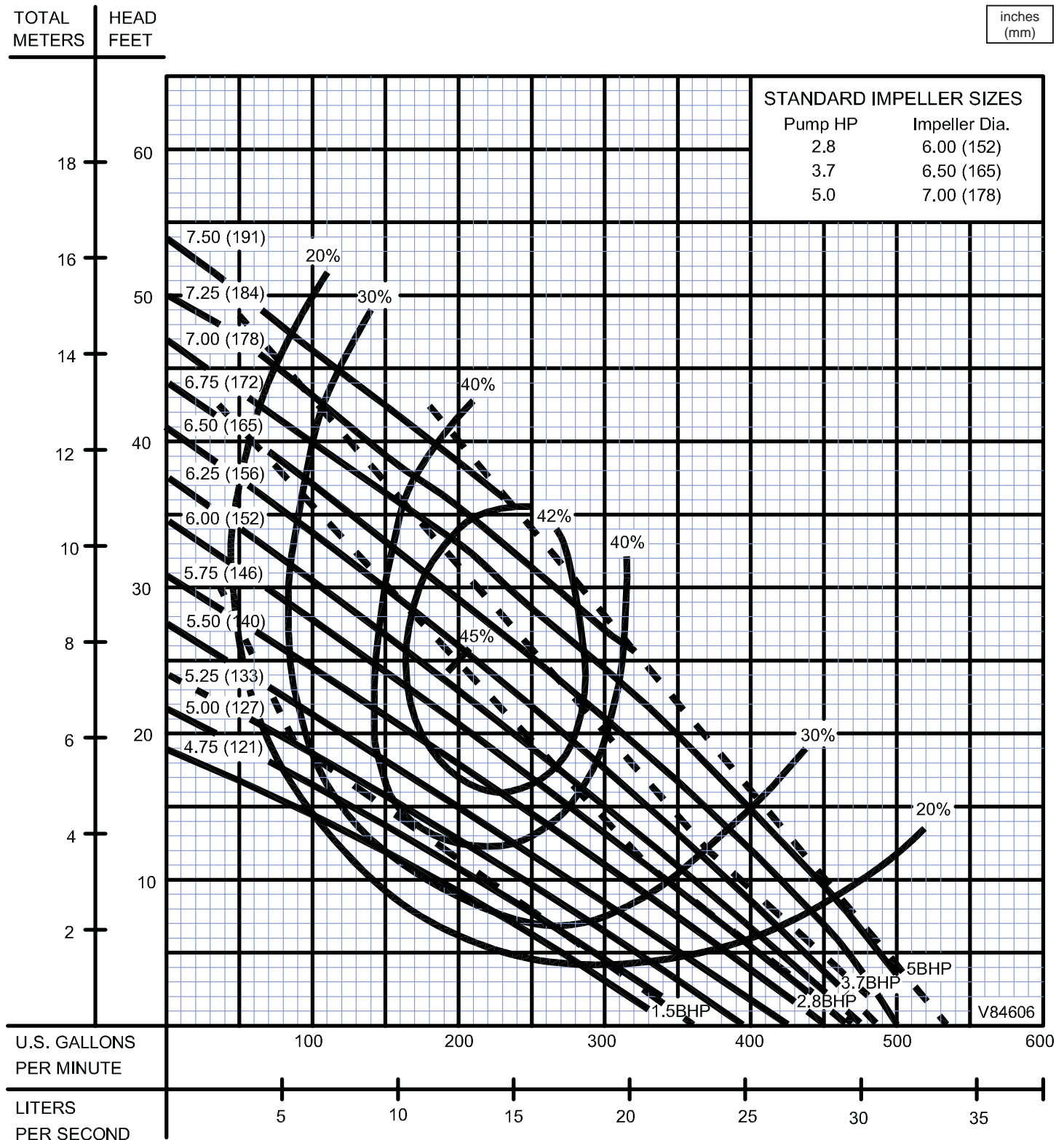

Testing is performed with water, specific gravity 1.0 @ 68° F @ (20°C), other fluids may vary performance

SECTION 1D
PAGE 10
DATE 1/05



A Crane Co. Company

PUMPS & SYSTEMS

USA: (937) 778-8947 • Canada: (905) 457-6223 • International: (937) 615-3598